



# Whitfield State School Master Plan 2021

Issue A 30/11/21

DET-16







**TPG** Architects

1/124 Collins Ave Edge Hill 4870

t (07) 4032 1944

e [cairns@tpgarchitects.com.au](mailto:cairns@tpgarchitects.com.au)

---

**Whitfield State School Masterplan**  
October 2021

**TPG**  
ARCHITECTS 



# Contents

**Introduction & Vision Statement**

Existing Site Plan	2
Site Analysis + Design Priorities	3
Master Plan	4
Master Plan Approach	5
Performing Arts & Music Floor Plan Ground - Seating/Performance Mode	6
Performing Arts & Music Floor Plan Ground - Flexible Learning Mode (seating retracted)	7
Performing Arts & Music Floor Plan Level 1	8
Performing Arts & Music Illustrations	9
OSHC Floor Plan	10
OSHC Illustrations	11
Multipurpose Hall Floor Plan	
Multipurpose Hall Illustrations	



---

# Introduction & Vision Statement

---

This Master Plan sets out a vision for Whitfield State School that incorporates three new buildings each targeted to service increased need and to expand

Whitfield State School's capacity to deliver tailored performing arts, music, environmental and sporting experiences for their students and the wider community.

This document opens a dialogue to show what is feasible and to what extent new projects may sit within the existing school facilities.

Located within Whitfield amongst an established residential area Whitfield State School has a 'village' feel much valued by parents, students and the school community. The green, open grounds, established trees and on site 'Forest' are assets the Master Plan seeks to celebrate and preserve as the moves toward the future.

The existing buildings predominately date from the 70s, are in fair condition, generally oriented East-West and connected via low height outdoor covered pathways. The character is generally 70s and 80's utilitarian with a mix of blockwork and transportable structures.

The Master Plan seeks to carefully add new buildings whilst maintaining as much as possible the existing site layout and infrastructure. The new works where possible seek to improve access, visibility and connection with the wider community. Key themes and ideas informing the design approach are:

## Public Interface and Arrival

- A stronger street presence to McManus Street for the school generally. The new Performing Arts building provides a prominent visual cue.
- Clearly delineate a public entry connection to the Performing Arts centre separate from the school grounds.
- Address lack of public car parking and provide increased staff parking.

## Celebrate the existing Site

- Retain as much as possible existing infrastructure whilst providing enhanced experience and amenity
- Any additional works are to be planned around the existing trees on the site.
- Celebrate the existing 'Forest' on site by increasing accessibility to it.

## Amenity, Environment and Play

- Expand facilities keeping in mind opportunities for incidental uses between buildings
- Imaginative nature play spaces and breakout spaces.
- Nature and Environmental access and learning.







## Existing Site Plan 2021

Scale 1:1000

2

Whitfield State School  
Master Plan October 2021

TPG  
ARCHITECTS



- 1 Maintain Existing Entries
- 2 Increase street presence to McManus St
- 3 Relocate Block 10
- 4 Maintain clearances to future building
- 5 Maintain clearances to existing trees
- 6 Formalise road/pathway to new building
- 7 Increase carparking capacity
- 8 Link new OSHC to Admin precinct
- 9 Relocate maintenance zone
- 10 Formalise link to Forest
- 11 Formalise access road
- 12 Create new environmental/sports precinct









# Master Plan

## 1 Performing Arts & Music PAC

The new Performing Arts & Music building provides a new prominent frontage to McManus Street promoting Whitfield State School to the local community. The building provides for multiple flexible uses for both the school and wider community use with facilities including; performance stage, green room, storage, indoor and outdoor flexible learning areas, fixed and retractable seating capacity of approximately 480 patrons and accessible amenities. The siting of the building takes advantage of the existing entry and pathway locations, formalising public entry under the existing raintree via a ring road for loading and unloading of large equipment.

## 2 Carparking

The new carparking arrangement draws upon the general planning of the existing carpark with the new masterplan attempting minor modification to maximise increased capacity. The existing drop of ring road is maintained and carparking capacity is increased generally from existing 45 spaces to 88 new spaces. The footprint is increased in North, East and Southern directions yet the existing vegetation to McManus street is maintained. A new ring road is added to service the new Performing Arts building and new pathway connection provided adjacent Block 3 for pedestrian access to the Arts precinct.

## 3 OSHC

The new OSHC provides for a capacity of 75 students and includes amenities, kitchenette, storage and staff area and outdoor nature play. The siting takes into consideration the existing tree and pathway layout adjacent the Administration and Staff areas allowing for passive security. Access pathway connections are provided via Administration and the existing entry located at Marino Street.

## 4 Maintenance Zone

The existing Maintenance sheds and new access road are formalised for ease of access from Marino Street. The existing location is maintained with new fencing and gates provided for additional separation from the new Sports and Environmental precinct.

## 5 Multipurpose Hall

The new Multipurpose Hall provides semi enclosed sporting facility with amenities and store for multiple sports including; netball, basketball, volleyball, badminton and indoor soccer. The building is sited to maximise connection to the adjacent oval.

## 6 Nature walk

An informal pathway and vegetation connecting the junior school precinct to the 'Forest' and environmental learning area. The path acts as a soft landscaping threshold between the sporting and environmental learning areas.

## 7 Environmental Learning

New landscaping elements added to create an immersive environmental learning area to take advantage of the existing site conditions.

## 8 Access Road

New formalised access road to complete pathway connections and provide vehicle entry to the Northern school zone.



## Master Plan Approach



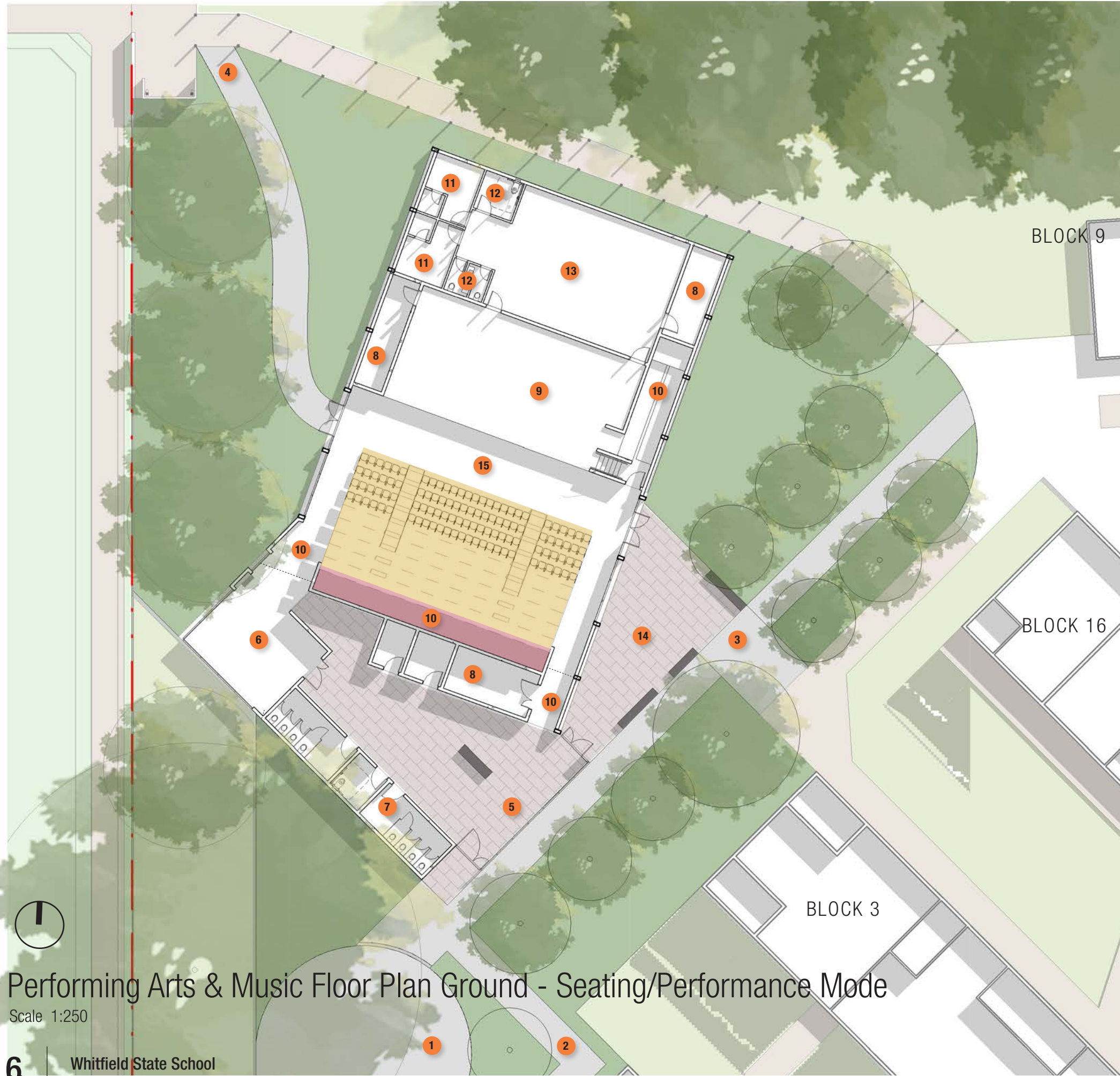

# Performing Arts & Music

The new Performing Arts & Music building provides a new prominent frontage to McManus Street promoting Whitfield State School to the local community. The building provides for multiple flexible uses for both the school and wider community use with facilities including; performance stage, green room, storage, indoor and outdoor flexible learning areas, fixed and retractable seating capacity of approximately 480 patrons and accessible amenities. The siting of the building takes advantage of the existing entry and pathway locations, formalising public entry under the existing raintree via a ring road for loading and unloading of large equipment.

- Retractable seating
- Fixed wall to house retractable seating

- 1 Ring road access
- 2 Pedestrian pathway link
- 3 Connection to existing pathways
- 4 New pathway connection to existing entry

## AREAS

5	Entry foyer	126m2
6	Flexible learning area/community use	39m2
7	Public amenities	36m2
8	Storage/Services	79m2
9	Stage	104m2
10	Ground level circulation	39m2
11	Green rooms	23m2
12	Back of stage accessible amenities	11m2
13	Back of stage FLA/practice room	92m2
14	Outdoor Covered courtyard	79m2
15	Ground level flexible learning area (refer plan p.7)	208m2
16	Level 1 Circulation (refer level 1 plan p.8)	24m2
17	Level 1 fixed tiered seating (refer level 1 plan p.8)	102m2
18	Level 1 Plant room & Store (refer level 1 plan p.8)	140m2

**TOTAL GFA** **1102m2**

Performing Arts & Music Floor Plan Ground - Seating/Performance Mode

Scale 1:250



# Performing Arts & Music



Performing Arts & Music Floor Plan Ground - Flexible Learning Mode (seating retracted)

Scale 1:250



# Performing Arts & Music



- Retractable seating
- Level 1 fixed tiered seating



Performing Arts & Music Floor Plan Level 1

Scale 1:250



# Performing Arts & Music



## Performing Arts & Music Illustrations



## Performing Arts & Music



### Performing Arts & Music Illustrations



## Performing Arts & Music



### Performing Arts & Music Illustrations



# OSHC

The new OSHC provides for a capacity of 75 students and includes amenities, kitchenette, storage and staff area and outdoor nature play. The siting takes into consideration the existing tree and pathway layout adjacent the Administration and Staff areas allowing for passive security. Access pathway connections are provided via Administration and the existing entry located at Marino Street.

- 1 Entry via existing entry at Marino St
- 2 Entry gate into OSHC outdoor area
- 3 Existing tree
- 4 Entry via existing pathway adjacent Administration precinct
- 5 Sandpit

### AREAS

6	Kitchenette	14m2
7	Office	9m2
8	Amenities	13m2
9	Store	14m2
10	Indoor learning area	243m2
11	Outdoor covered area	45m2

### TOTAL GFA

338m2

- 12 Outdoor area & nature play

730m2



## OSHC Floor Plan

Scale 1:250





## OSHC Illustrations



# Multipurpose Hall

The new Multipurpose Hall provides semi enclosed sporting facility for multiple sports including; netball, basketball, volleyball, badminton and indoor soccer. The building is sited to maximise connection to the adjacent oval.

An informal pathway and vegetation connecting the junior school precinct to the 'Forest' and environmental learning area. The path acts as a soft landscaping threshold between the sporting and environmental learning areas.

- 1 New landscape
- 2 New compacted roadbase access road
- 3 New concrete pathway connection

### AREAS

4 Multipurpose Hall	1040m2
5 Covered outdoor area	185m2
6 M/F Amenities & Accessible WC	49m2
7 Store	82m2

**TOTAL GFA** **1356m2**

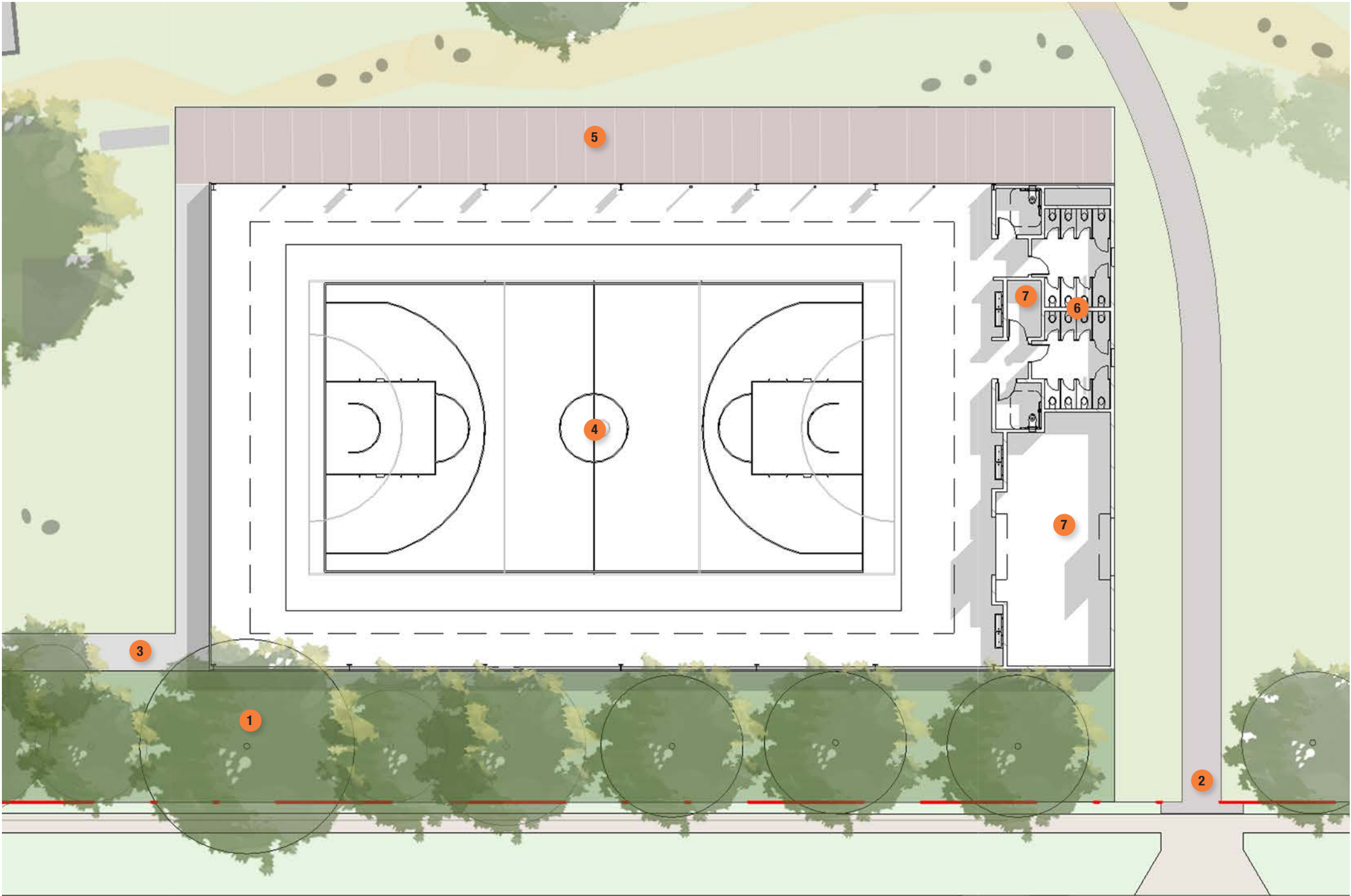

## Multipurpose Hall Floor Plan

Scale 1:500



# Multipurpose Hall



## Multipurpose Hall Illustrations



# Multipurpose Hall



## Multipurpose Hall Illustrations